

Hako

Assembly Instructions

Assembly manual

**Front-Lighting system (6341) for
Sweepmaster P/D/B 1200 RH**

Einführung

Preface

We recommend conversion with a Hako base.

These assembly instructions should only be used in conjunction with the machine's operating instructions.

Safety Instructions

Please note the general safety regulations for the relevant machine from the applicable operating instructions.

Before starting assembly, park the vehicle on a level surface and secure it with the parking brake. Stop the engine and remove the ignition key.

We expressly point out that any legal claims relating to the statements in these instructions cannot be asserted. If repair work is required, please ensure that only original replacement parts are used. Because only original spare parts guarantee that your device will be in constant and reliable use. We reserve the right to make changes in the interest of technical development.

Valid from: August 2016

Hako GmbH
D-23843 Bad Oldesloe
Hamburger Str. 209-239
Telefon +49 4531 806-0

The assembly instructions for the front lighting system 12/24V (6341) apply to:

- Sweepmaster P1200 RH
- Sweepmaster D1200 RH
- Sweepmaster B1200 RH

Front Lighting System

1 Front lighting system

1.1 Set of parts

1 Work lights left/right, consisting of.

- Indicator
- Indicator holder
- Work lights with holder
- Protective Bar
- Edge Protection

2 Switch S8

3 Fuse insert:

- 1x10A and 1x 15A for 12V .
- or 2x 10A for 24V

4 Flasher relay:

- K6 for 12V or
- K9 for 24V

Parts not shown:

- Fastening Material
- Wiring Harness W13, see section 1.6.



Abb.1

Front-Lighting System

1.2 Install work lights

1. Park the machine on a level surface and secure it with the parking brake.
2. Stop the engine and remove the key or remove the battery connector.
3. Remove the metal sheets (Fig. 2/1) from the chassis (Fig. 2/2) and install the edge protection.
4. Mount the turn signal (Fig. 2/3) on the turn signal holder (Fig. 2/4) using Ejet screws and washers.
5. Insert the indicator holder (Fig. 2/4) on the chassis (Fig. 2/2) from the inside.
6. Insert the work light (Fig. 2/5) into the indicator holder, fasten it to the chassis with the protective bracket (Fig. 2/6) and fastening material (screws M8x20mm, washers 8.4 and nuts M8).
7. Connect wiring harness W13 to connector X10 (right side in the chassis) and the work lights. Fasten the wiring harness with cable ties

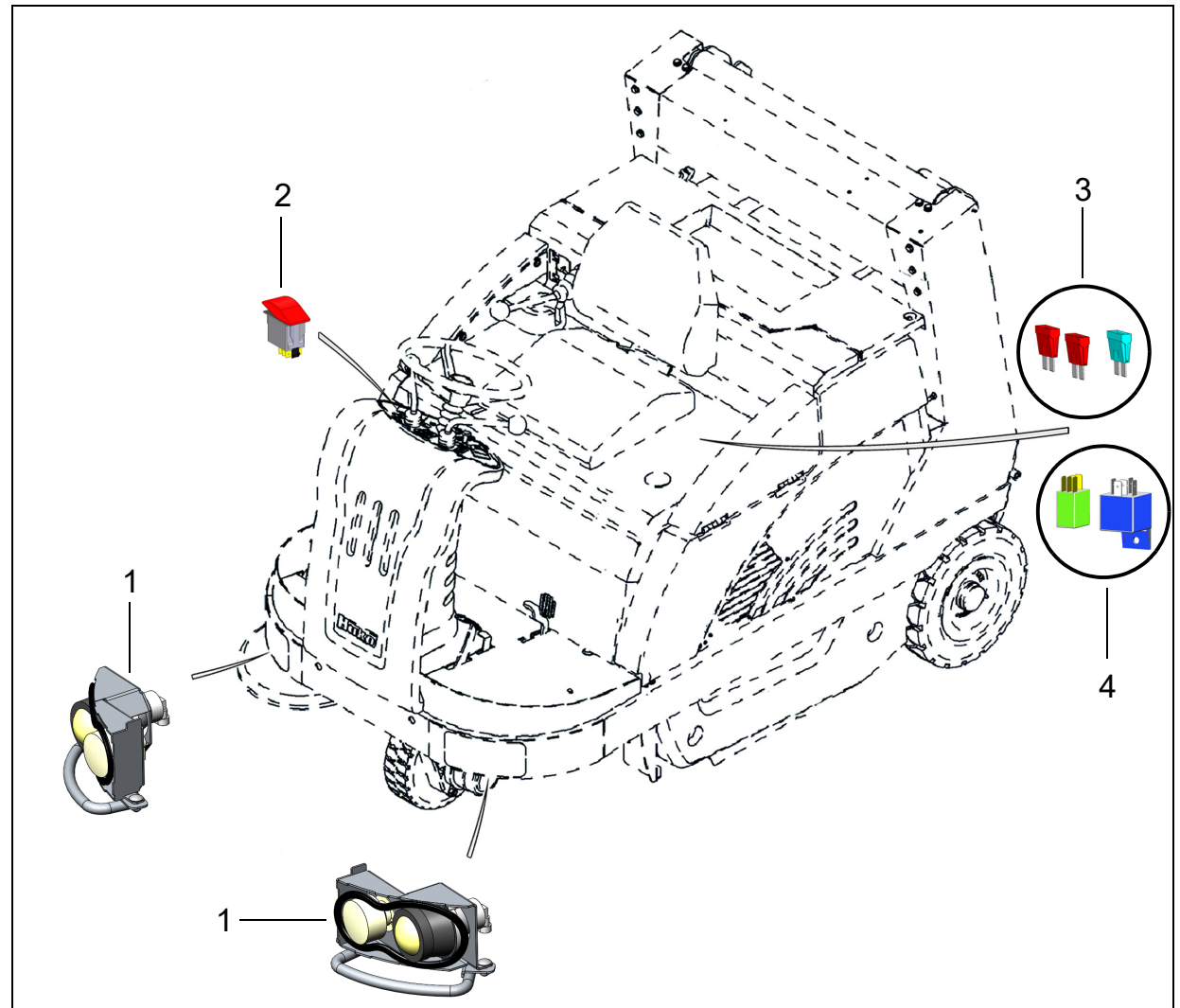
The electrical connection must be made according to the circuit diagram, see section 1.6.



Abb.2

Front Lighting System

1.3 Install switch S8

1. Unscrew the control panel (Fig. 3/1) and remove the blind plug (Fig. 3/2).
2. Lift the control panel until the plug of the wiring harness W11 is visible.
3. Set switch @8 in the control panel and connect it to the plug of the wiring harness W11. Reinstall the control panel.

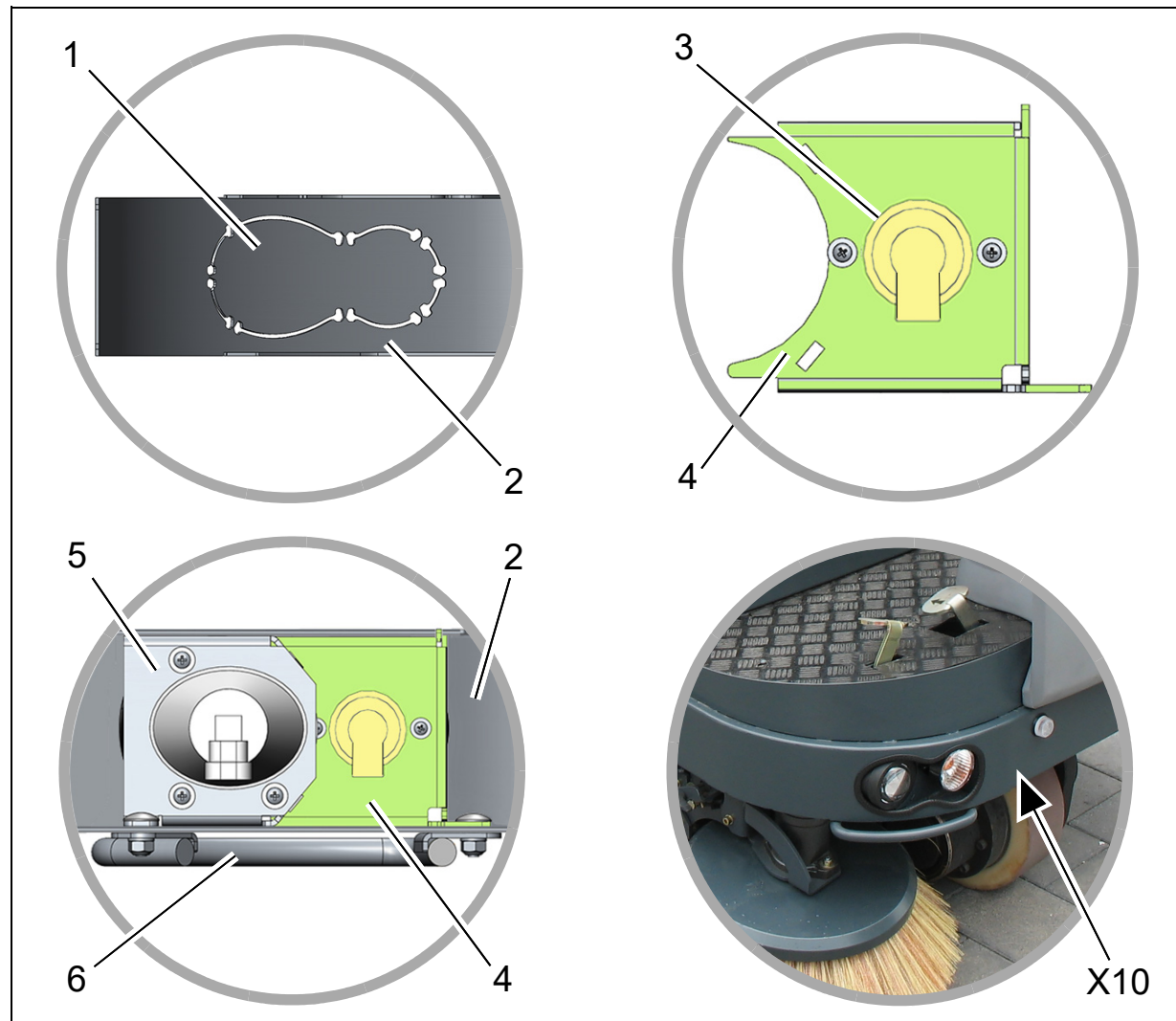
The electrical connection must be made according to the circuit diagram, see section 1.6.



Abb.3

Front Lighting System

1.4 Install fuses and relays

Sweepmaster B1200 RH

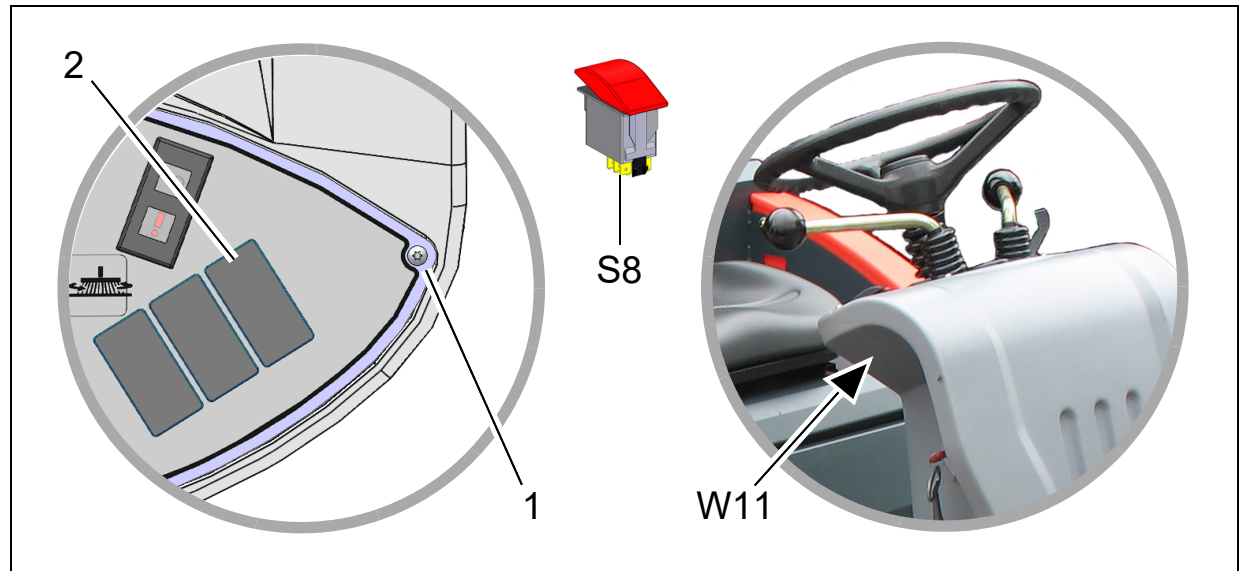
- Remove the cover of the electrical box and insert fuses.
- - F10 and F11=10A
- Plug the relay K9 into the socket housing.

1.5 Adjust work lights

Make sure that the work lights (Fig. 4/1) are adjusted correctly. The adjustment is made with the three screws (Fig. 4/2).



Abb.4

Front-Beleuchtungsanlage

1.6 Schaltplan

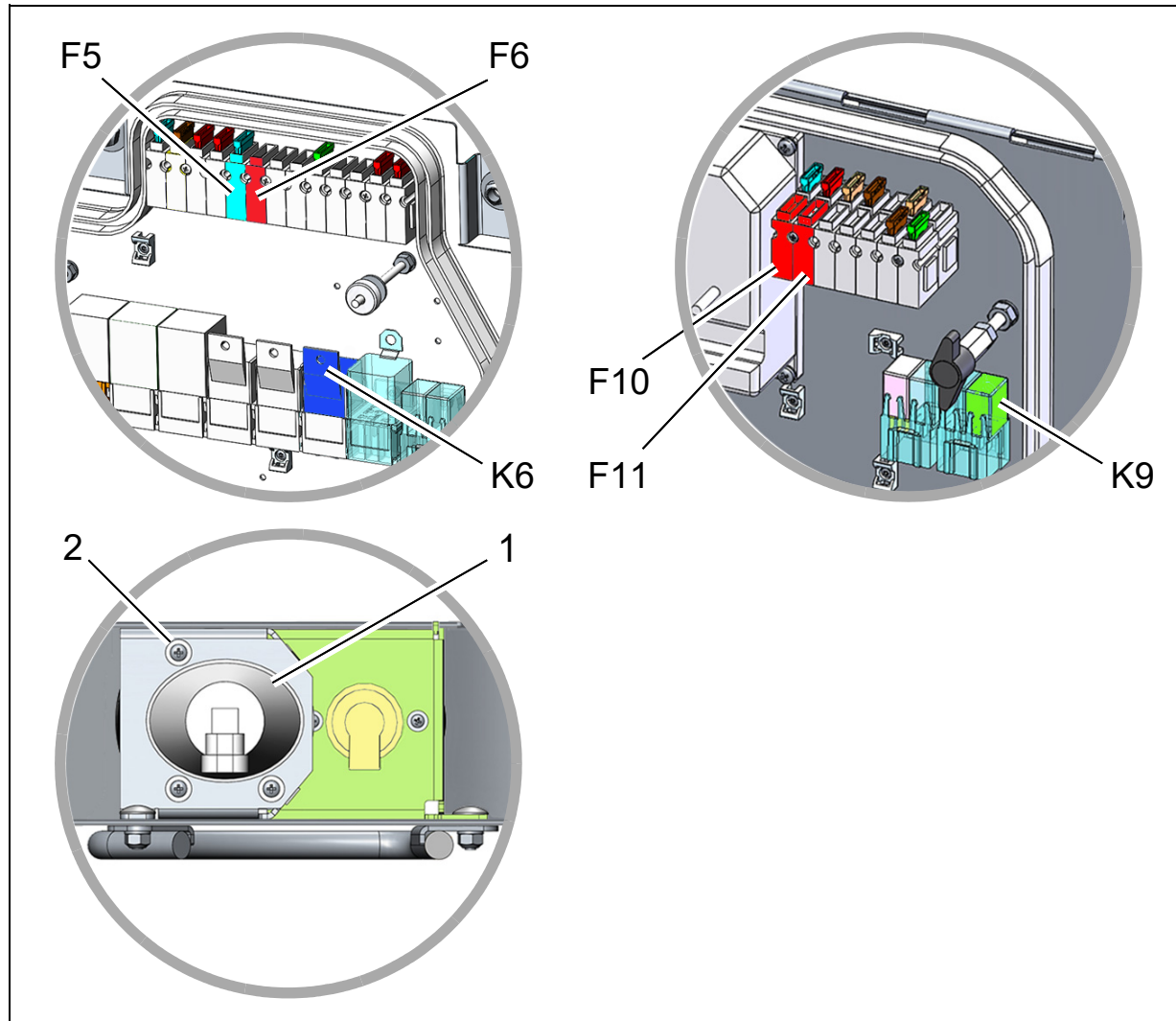
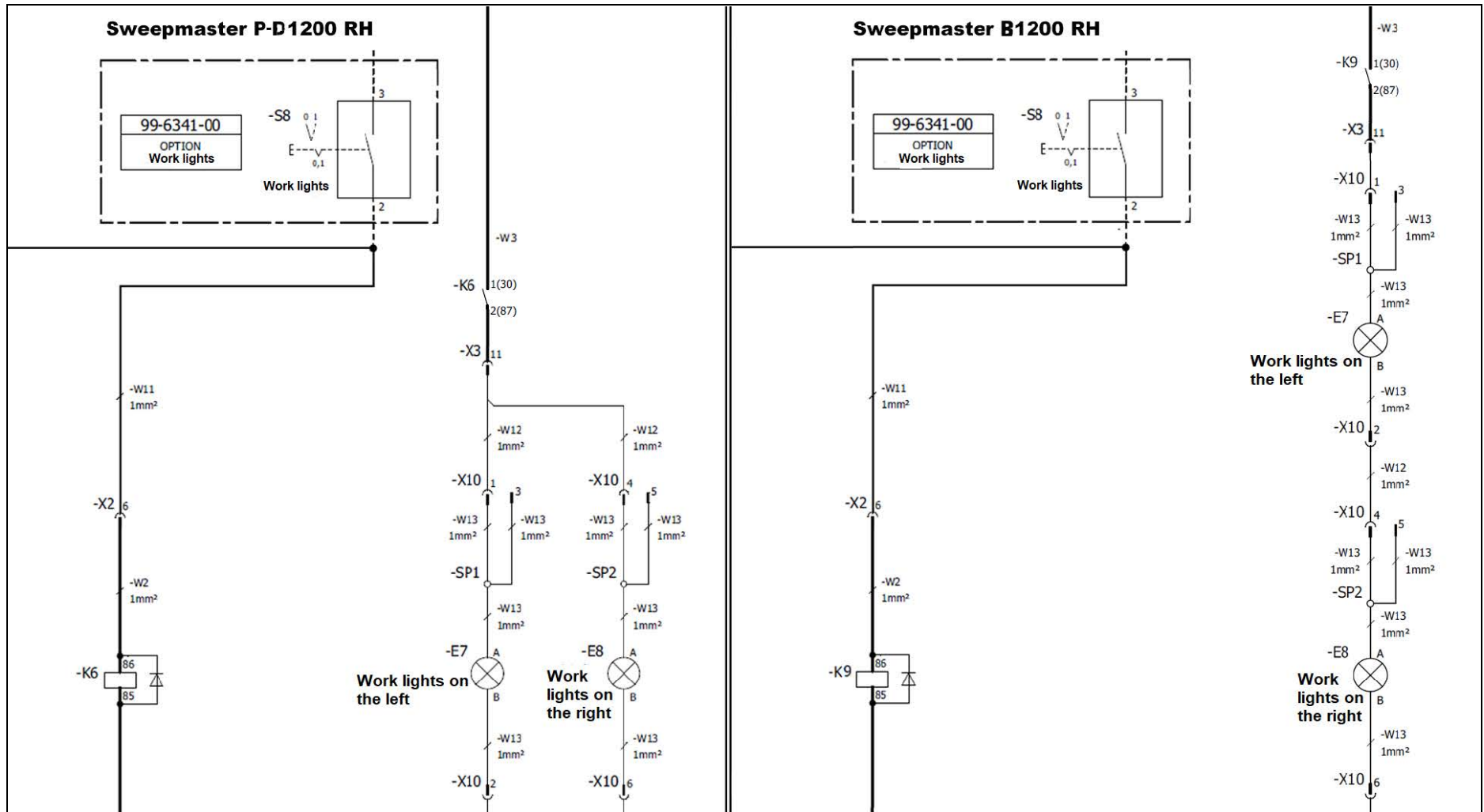

Abb.5



88-00-3178 - 4079-00

Hako GmbH
Unternehmenszentrale
Hamburger Str. 209-239
23843 Bad Oldesloe
Deutschland
Tel. +49 4531 806-0
info@hako.com
www.hako.com